

notes
 This drawing is the copyright © property of Hypostyle Designs Ltd - no copying or distribution of this drawing or any part thereof is permitted without prior written permission.
 Do not scale from this drawing. All existing dimensions to be checked on site prior to commencement of works or manufacturing of components.
 Any discrepancies to be brought to the attention of the architect - if in doubt, ask.

S.H.E - safety health & environment information

- Demolition of plant room. This plant room is known to contain Asbestos. Refer to Asbestos report for location(s). Removal to be carried out by specialist contractor.
- Deep excavations anticipated.
- Restricted access, uneven terrain, overhanging mature trees.
- Uneven bedrock floor containing fossilised tree stumps and trunks. The ground floor is a Site of Special Scientific Interest. As such, strict rules will be in place for access routes through and for moving materials, plant and waste. Also for carrying out construction activities and dealing with the waste products of those activities.
- Restricted access to work area. Beams to be treated are within a shallow pocket approximately 1100mm high and also constrained for a third of their length by the adjacent deck. All in close proximity to bedrock to be protected from substances being applied.
- Access (gresso to and from the bedrock floor is afforded at an end of the building only. Ensure clear access is maintained. Building requires to remain secure while allowing exit in emergency.

symbol indicates location & ref. no. of residual hazard/risk

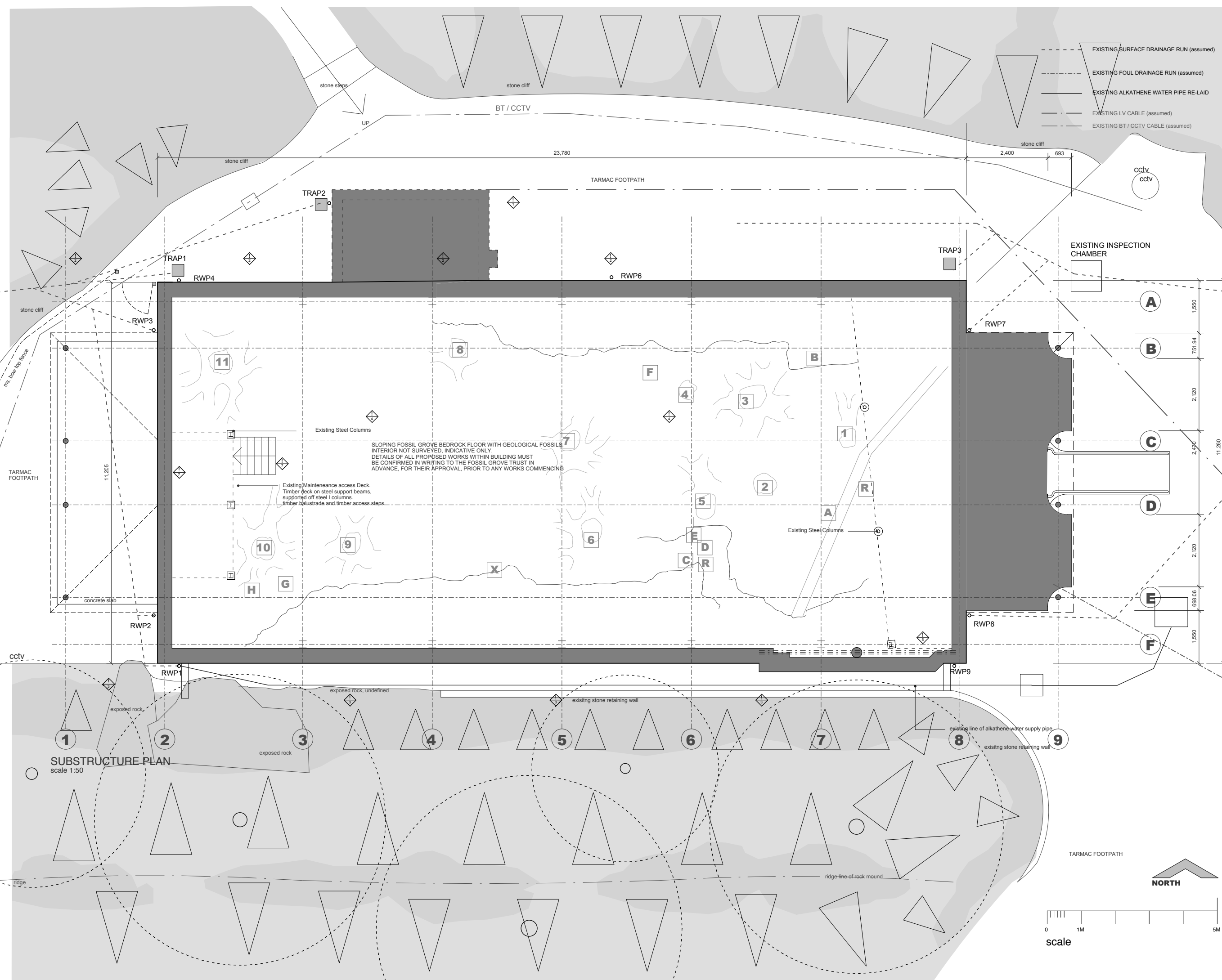

SLOPING FOSSIL GROVE BEDROCK FLOOR WITH GEOLOGICAL FOSSILS
 INTERIOR NOT SURVEYED, INDICATIVE ONLY.
 DETAILS OF ALL PROPOSED WORKS WITHIN BUILDING MUST
 BE CONFIRMED IN WRITING TO THE FOSSIL GROVE TRUST IN
 ADVANCE, FOR THEIR APPROVAL, PRIOR TO ANY WORKS COMMENCING

Existing Maintenance access Deck.
 Timber deck on steel support beams,
 supported off steel I columns,
 timber balustrade and timber access steps.

SUBSTRUCTURE PLAN
 scale 1:50

CONSTRUCTION ISSUE

A	NOTED AS CONSTRUCTION ISSUE	SR	SR	20.02.2
rev.	amendment	by	checked	date

HYPPOSTYLE
 ARCHITECTS
 www.hypostyle.co.uk

Glasgow 49 St. Vincent Crescent G3 8NG
 T: 0141 204 4441 F: 0141 204 4897 E: glasgow@hypostyle.co.uk
 Edinburgh 4 Sandport Place EH6 6EU
 T: 0131 555 0688 F: 0131 553 4450 E: edinburgh@hypostyle.co.uk

client
CITY BUILDING (GLASGOW) LLP

client's ref
 project
**FOSSIL GROVE, VICTORIA PARK
 GLASGOW**

drawing
**SUBSTRUCTURE PLAN
 AS EXISTING**

scale 1:50	page size A1	drawn SR	checked SR
job ref 3989	drawing num AL(0)111	date June 24	date June 24
			rev A